

产品规格书  
PRODUCT SPECIFICATION

客户名称/Customer	
客户料号/Part No.	
客户承认签章 Customer Approved Signatures	

供方/Supplier	友容新源电气（昆山）有限公司 Cfriend Electric (kunshan) Co.,Ltd
文件编号/Spec No.	CF-PS220119004
品名/Description	FUSE
型号/Model	CFM9***DT
日期/Date	2021. 5. 8
设计/Designed	批准/Approved
胡曾	kevin

地址：中国江苏省昆山市周市镇陆扬友谊北路153号  
ADD:No.153, Youyi North road, Zhoushi Town, Kunshan City,  
Jiangsu Province in china

电话/Tel: 86-512-36698841

传真/Fax: 86-512-36698843

Http: [www.cfriend-electric.com](http://www.cfriend-electric.com)

# CFM-FUSES Fuses for Semiconductor Protection IEC60269-4/GB/T13539.4 standard

Size	Rated Voltage	Operating Class	Rated Breaking Capacity
------	---------------	-----------------	-------------------------

000	ac 690V	a R	690V@100kA
-----	---------	-----	------------

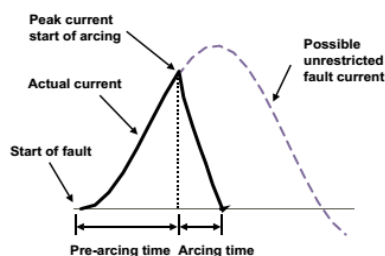

## 型号 Product model

- CFM9010DT~CFM9315DT

## 型号诠释 Product Illustration

C F M 9 □□□ D T  
 ① ② ③ ④ ⑤ ⑥ ⑦

- ① 交流快速半导体保护用熔断体 (AC fast-acting fuses for semiconductor protection)
- ② 额定电压(Rated Voltage): F 690Vac
- ③ 安装方式(Way of Mounting): M 插入式安装 (DIN43620刀型)
- ④ 管号规格(Size): 9 9号管 (size 000)
- ⑤ 额定电流(Rated Current): A
- ⑥ 安装距离(Mounting Distance): D 78mm
- ⑦ 指示类型(Type of Indication): T (T Order)

## 描述 Description

- 安全可靠的螺栓连接方式 (Safe and reliable connection way of bolting)
- 优越的电气性能，迅速切断系统中的故障电流。  
(Excellent electric performance, cut down fault current fastly)
- 设计符合 IEC60269-4/GB/T13539.4 (Design according to IEC60269-4/GB/T13539.4)
- 产品过程符合IATF16949质量管理体系要求 (Product Process Conforms to IATF16949)
- 产品符合RoHS (Product conform to ROHS)

## 外形尺寸 Dimensions

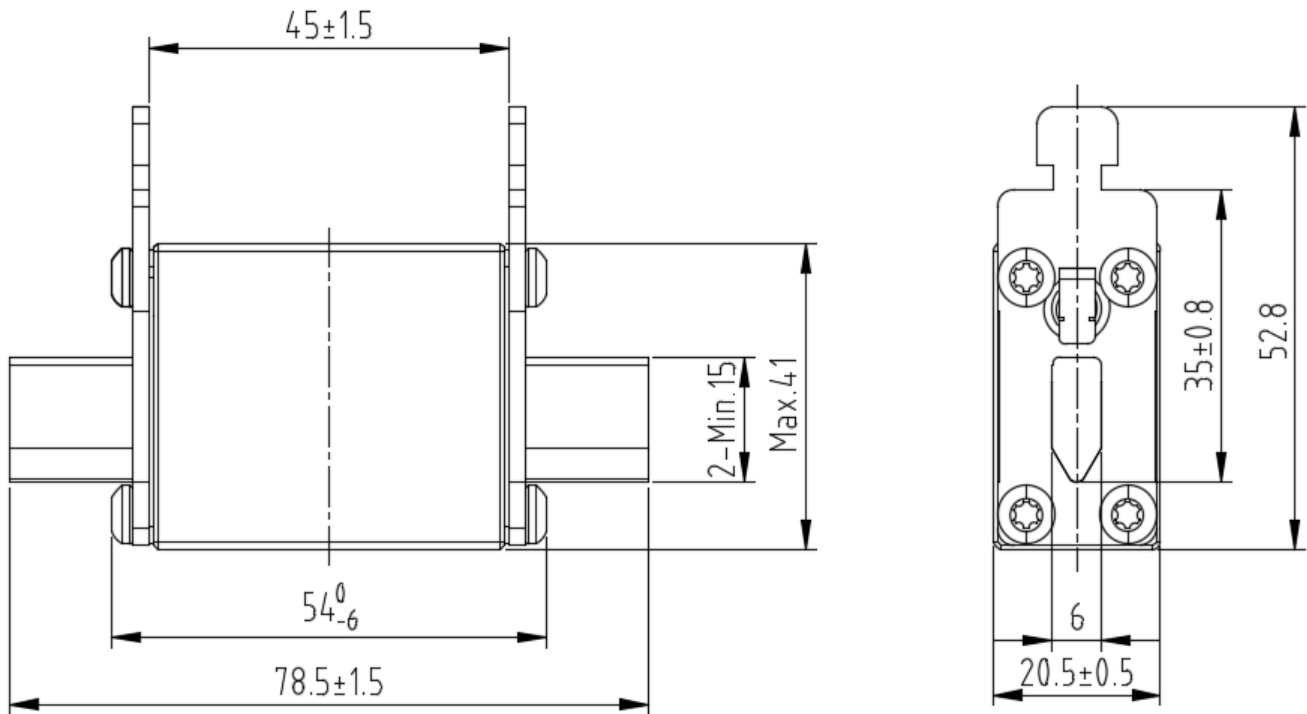

## 物料选择 Selection and ordering data

Rated current 【A】	Rated voltage 【V】	Part Number	Power Loss 【w】	Pre-arcing $I^2t$ 【A <sup>2</sup> S】	Total @690V $I^2t$ 【A <sup>2</sup> S】	Weight 【Kg/1pcs】	Pack
10	690	CFM9010DT	3	3.5	30	0.35	3
16		CFM9016DT	3.7	6.5	50		
20		CFM9020DT	4.5	10	82		
25		CFM9025DT	3.5	18	150		
32		CFM9032DT	4.5	35	300		
40		CFM9040DT	5	65	500		
50		CFM9050DT	8	110	800		
63		CFM9063DT	10	210	1500		
80		CFM9080DT	15	400	2600		
100		CFM9100DT	17	680	4800		
125		CFM9125DT	20	1100	8500		
160		CFM9160DT	26	2200	16000		
200		CFM9200DT	32	4000	28000		
250		CFM9250DT	37	7700	52000		
315		CFM9315DT	50	12000	81000		

## 时间电流特性曲线 Time- Current Characteristics Curve

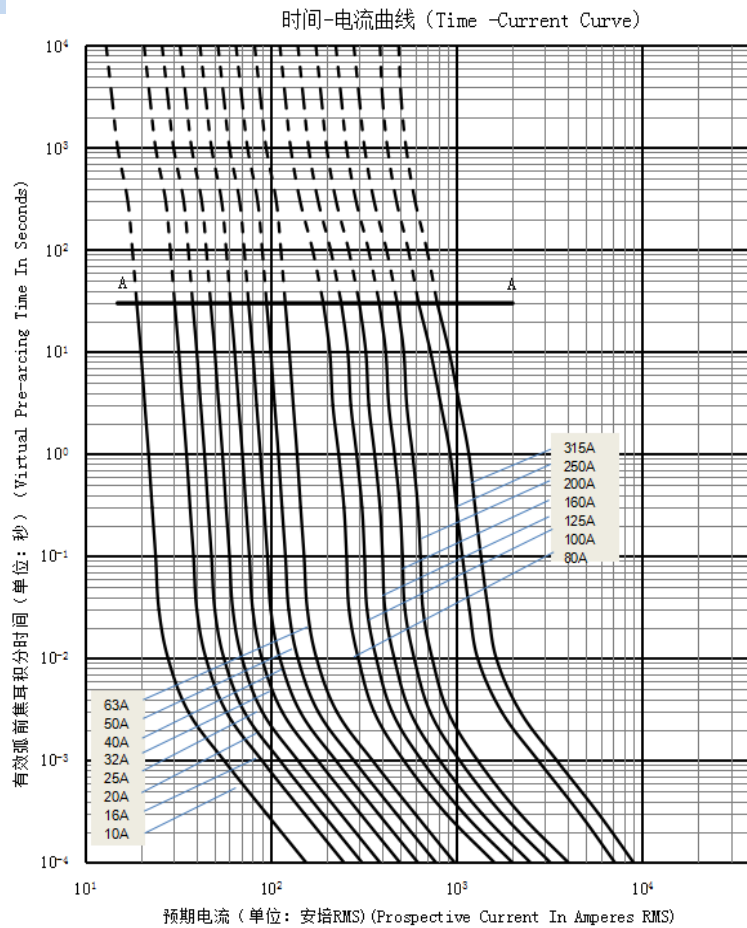

## 使用条件 Operating condition

No	项目 Item	要求 Requirements
1	使用电压范围 Operating voltage	$\leq 690V$
2	使用环境 Operating environment	$-5^{\circ}C \sim 85^{\circ}C$ $RH < 50\% (\geq 40^{\circ}C)$ $RH < 90\% (\leq 20^{\circ}C)$
3	保存环境 Storage environment	$-5^{\circ}C \sim 40^{\circ}C$ $RH < 75\%$
4	海拔高度 altitude	$\leq 2000m$ (超过范围请联系厂商)
5	安装扭矩 Install torque	
6	污秽等级 Pollution level	III