

产品规格书
PRODUCT SPECIFICATION

客户名称/Customer	
客户料号/Part No	
客户承认签章 Customer Approved Signatures	

供方/Supplier	友容新源电气（昆山）有限公司
文件编号/Spec No	CF-PS0808005
品名/Description	FUSE
型号/Model	ETxx
日期/Date	08/02/2018
设计/Designed	批准/Approved
胡曾	Kevin

地址：中国江苏省昆山市周市镇陆扬友谊北路153号
ADD:No.153, Youyi North road, Zhoushi Town, Kunshan City,
Jiangsu Province in china

电话/Tel: 86-512-36698841 传真/Fax: 86-512-36698843

Http: www.cfriend-electric.com

ET-FUSES Fuses for Semiconductor Protection
IEC60269-4/IEC60269-1 standard

SIZE	Rated Voltage	Operating Class	Rated Breaking Capacity
------	---------------	-----------------	-------------------------

18	690Vac	a R	690V@100kA
----	--------	-----	------------

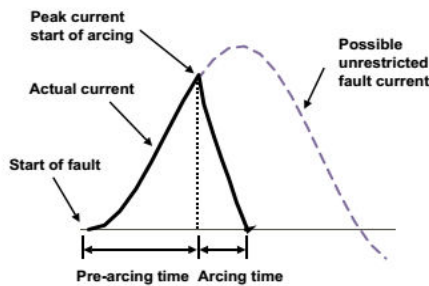

型号 Product model

- ET□□

型号诠释 Product interpretation

E T □□
① ② ③

- ① 额定电压 Rated Voltage: E:690Vac
- ② 直径 Diameter: T:18mm
- ③ 额定电流 Rated Current: A

描述 Description

- 安全可靠的螺栓连接方式 Safe and reliable connecting way of bolt-on
- 优越的电气性能，迅速切断系统中的故障电流。

Excellent electric performance, cut down the fault current of the system.

- 设计符合 IEC60269-4 Product design conforms to IEC60269-4
- 产品过程符合IATF16949质量管理体系要求 Product process conforms to IATF16949
- 产品、包装符合RoHS Product and Package conforms to RoHS

外形尺寸 Dimensions

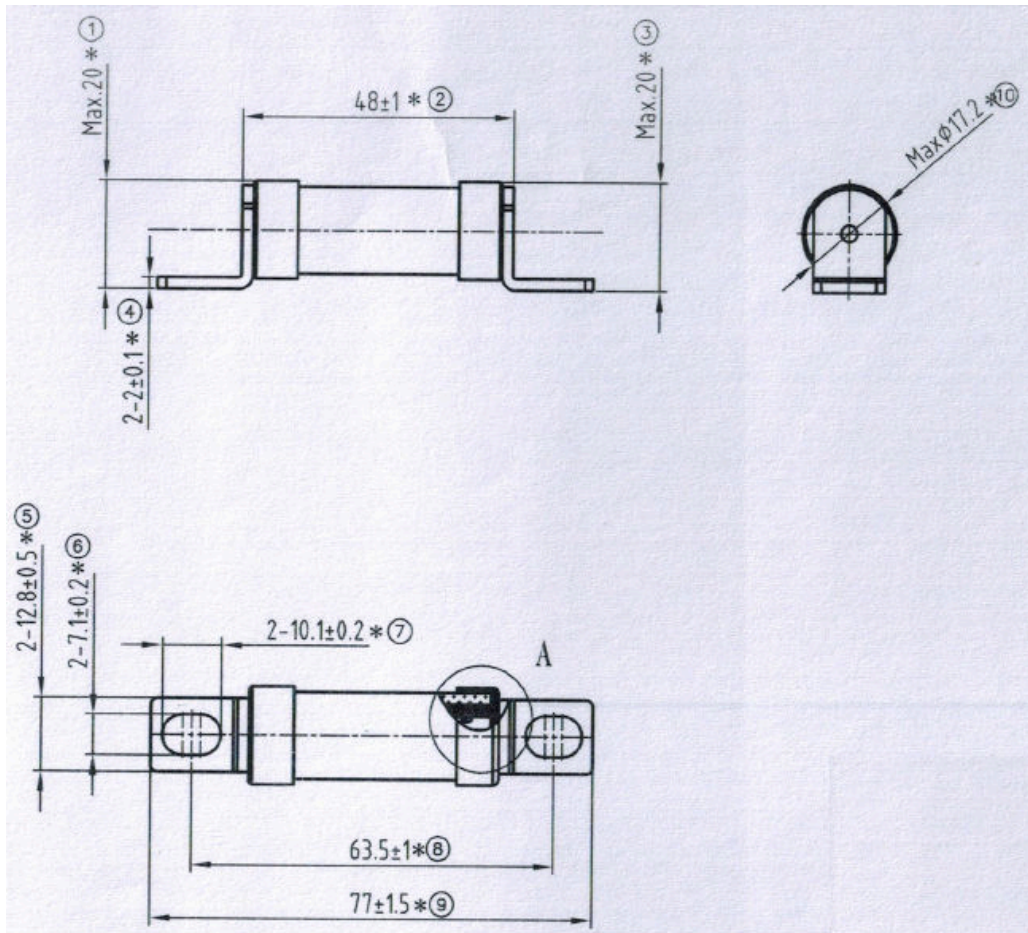

物料选择 Selection and ordering data

Rated current 【A】	Rated voltage 【V】	Part Number	Power Loss 【W】	Pre-arcing i^2t 【A ² S】	Total @690V i^2t 【A ² S】	Weight 【Kg/1】	Pack
6	690Vac	ET6	1.7	1.8	12	0.04	1
10		ET10	2.64	7	48		
12		ET12	3	10	65		
16		ET16	3.83	16	110		
20		ET20	4.7	32	220		
25		ET25	5.9	25	250		
32		ET32	7.9	32	350		
35		ET35	8.1	50	550		
40		ET40	8.4	100	950		
45		ET45	8.55	105	1100		
56		ET56	9.56	130	1550		
63		ET63	12.6	170	2000		
80		ET80	15.2	350	4500		

时间电流特性曲线 Time- Current Characteristics Curve

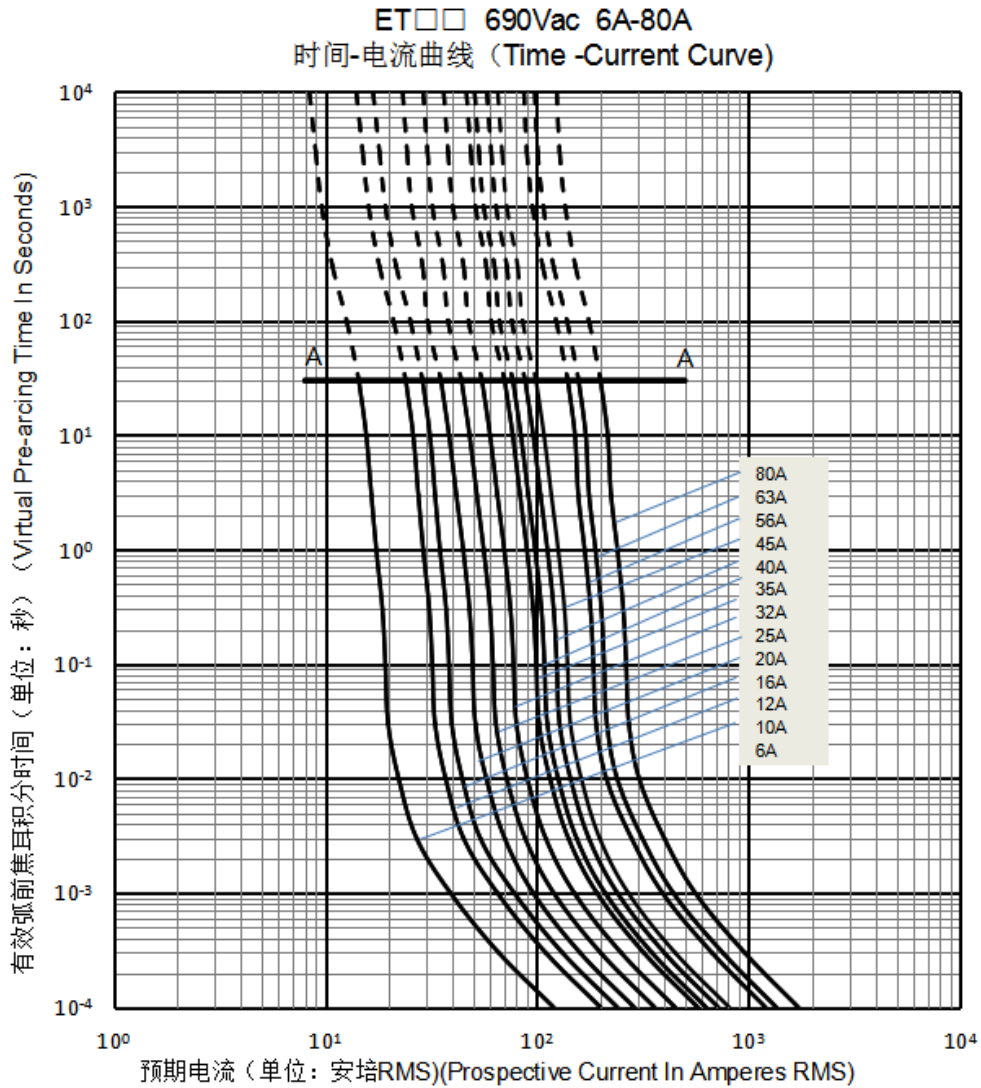

使用条件 Operating condition

No	项目 Item	要求 Requirements
1	使用电压范围 Operating voltage	≤690V
2	使用环境 Operating environment	-40℃~85℃ RH<50%(≥40℃) RH<90%(≤20℃)
3	保存环境 Storage environment	-5℃~40℃ RH<75%
4	海拔高度 altitude	≤3000m(超出范围请咨询厂商)
5	安装扭矩 Install torque	M6 4.5±0.5N.m
6	污秽等级 Pollution level	III