

产品规格书
PRODUCT SPECIFICATION

客户名称/Customer	
客户料号/Part No	
客户承认签章 Customer Approved Signatures	

供方/Supplier	友容新源电气（昆山）有限公司
文件编号/Spec No	CF-PS0809004
品名/Description	FUSE
型号/Model	FDH-(225-400)A
日期/Date	09/10/2018
设计/Designed	批准/Approved
胡曾	kevin

地址：中国江苏省昆山市周市镇陆扬友谊北路153号
ADD:No.153, Youyi North road, Zhoushi Town, Kunshan City,
Jiangsu Province in china

电话/Tel: 86-512-36698841 传真/Fax: 86-512-36698843

Http: www.cfriend-electric.com

FDH-FUSES Fuses for Semiconductor Protection
IEC60269-4/JASO D622/ISO8820 standard

SIZE	Rated Voltage	Operating Class	Rated Breaking Capacity
------	---------------	-----------------	-------------------------

36	dc 500v	aR	20kA
	ac 500v		100kA

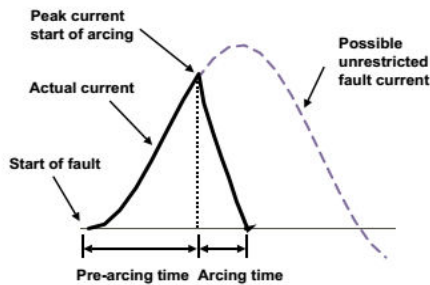

型号 Product model

- FDH-□□□A

型号诠释 Product interpretation

FD H-□□□A
① ② ③

- ①美式安装快速半导体设备保护用熔断体
- ②电压等级 Rated voltage : H:500V
- ③额定电流 Rated current : A

描述 Description

- 安全可靠的螺栓连接方式 Safe and reliable connecting way of bolt-on
- 优越的电气性能，快速保护EV汽车系统，迅速切断系统中的故障电流。
Excellent electric performance, quick protection for EV system, cut down the fault current of the system.
- 设计符合 IEC60269-4 Product design conforms to IEC60269-4
- 产品过程符合IATF16949质量管理体系要求 Product process conforms to IATF16949
- 产品、包装符合RoHS Product and Package conforms to RoHS

外形尺寸 Dimensions

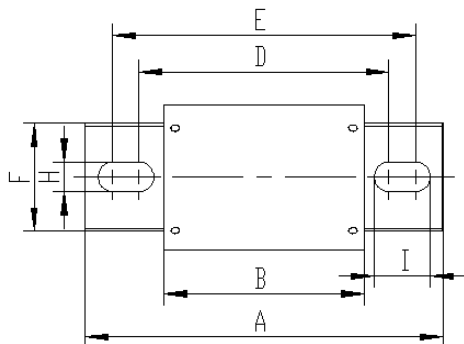

单位/ unit: mm

A	110 +1.5/-1.5
B	53 +0.5/-0.1
C	36 +0.2/0
D	70 +1/-1
E	87 +1/-1
F	26 +0.2/-0.2
G	6 +0.2/-0.2
H	10.5 +0.5/-0.5
I	19 +0.5/-0.5

物料选择 Selection and ordering data

Rated current 【A】	Rated voltage 【V】	Part Number	Power Loss 【w】	Pre-arcing 【A2S】	Total 12t 【A2S】	Weight 【Kg/1】	Pack
250	500V	FDH-250A	25	6000	30700	0.3	1
275		FDH-275A	28	8100	39000		
300		FDH-300A	30	12000	48900		
325		FDH-325A	35	14200	61800		
350		FDH-350A	40	16300	70800		
400		FDH-400A	50	20500	93000		

时间电流特性曲线 Time- Current Characteristics Curve

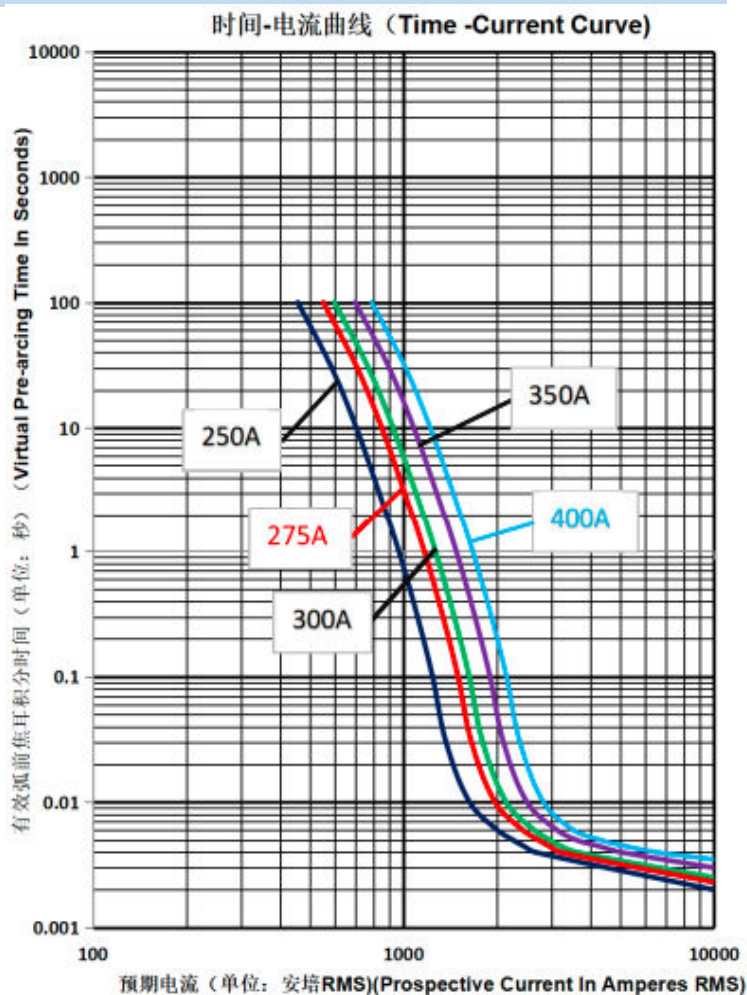

使用条件 Operating condition

No	项目 Item	要求 Requirements
1	使用电压范围 Operating voltage	$\leq 500V$
2	使用环境 Operating environment	$-40^{\circ}C \sim 85^{\circ}C$ $RH < 50\% (\geq 40^{\circ}C)$ $RH < 90\% (\leq 20^{\circ}C)$
3	保存环境 Storage environment	$-5^{\circ}C \sim 40^{\circ}C$ RH < 75%
4	海拔高度 altitude	$\leq 2000m$ (超过范围请咨询厂商)
5	安装扭矩 Install torque	M10 22 ± 1N.m
6	污秽等级 Pollution level	III