

产品规格书
PRODUCT SPECIFICATION

客户名称/Customer	
客户料号/Part No	
客户承认签章 Custome Approved Signatures	

供方/Supplier	友容新源电气（昆山）有限公司
文件编号/Spec No	CF-PS21120905
品名/Description	FUSE
型号/Model	FDP-(125-200)A
日期/Date	04/15/2019
设计/Designed	批准/Approved
胡曾	kevin

地址：中国江苏省昆山市周市镇陆扬友谊北路153号
ADD:No.153, Youyi North road, Zhoushi Town, Kunshan City,
Jiangsu Province in china

电话/Tel: 86-512-36698841 传真/Fax: 86-512-36698843

Http: www.cfriend-electric.com



FDP-FUSES Fuses for Semiconductor Protection IEC60269-4 standard

SIZE	Rated Voltage	Operating Class	Rated Breaking Capacity
36	700	aR	700Vdc@ 20kA 700Vac@ 100kA

型号 Product model

- FDP-□□□A

型号诠释 Product interpretation

FD P- □□□A
 ① ② ③

- ①北美熔断器 North American fuse
- ②额定电压 Rated Voltage :P 700Vac/dc
- ③额定电流 Rated Current :A

描述 Description

- 安全可靠的螺栓连接方式 Safe and reliable connecting way of bolt-on
- 优越的电气性能，迅速切断系统中的故障电流。
Excellent electric performance, cut down the fault current of the system.
- 设计符合 IEC60269-4 Product design conforms to IEC60269-4
- 产品过程符合IATF16949质量管理体系要求 Product process conforms to IATF16949
- 产品、包装符合RoHS Product and Package conforms to RoHS

外形尺寸 Dimensions

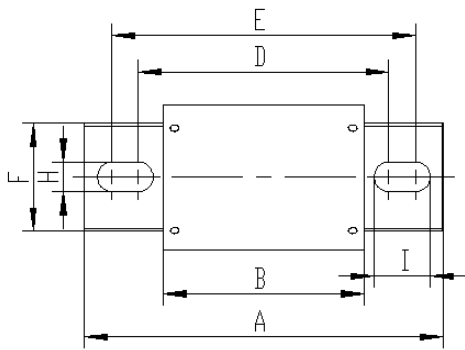

单位/ unit: mm

A	129 +1.5/-1.5
B	71 +0.5/-0.1
C	36 +0.2/0
D	89 +1/-1
E	106 +1/-1
F	26 +0.3/-0.3
G	6 +0.2/-0.2
H	11 +0.5/-0.5
I	19 +0.5/-0.5

物料选择 Selection and ordering data

Rated current 【A】	Rated voltage 【V】	Part Number	Power Loss 【W】	Pre-arcing i^2t 【A ² S】	Total @700V i^2t 【A ² S】	Weight 【Kg/1】	Pack
125	700	FDP-12A	22	1850	8000	0.3	1
150		FDP-150A	32	3023	13000		
200		FDP-200A	41	5850	23000		

时间电流特性曲线 Time- Current Characteristics Curve

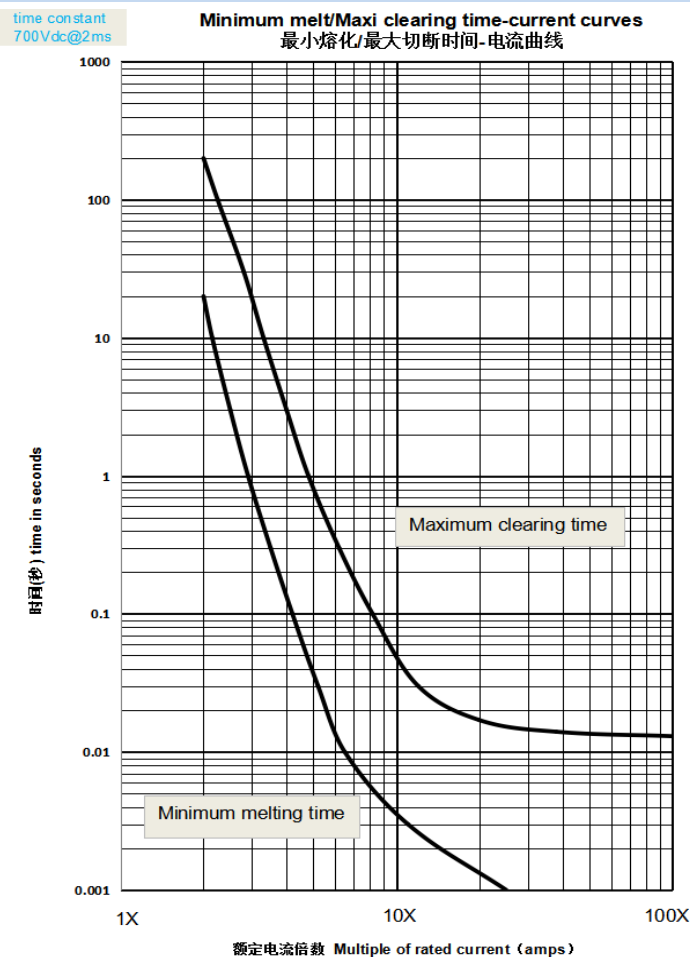

使用条件 Operating condition

No	项目 Item	要求 Requirements
1	使用电压范围 Operating voltage	$\leq 700V$
2	使用环境 Operating environment	$-40^{\circ}C \sim 85^{\circ}C$ $RH < 50\% (\geq 40^{\circ}C)$ $RH < 90\% (\leq 20^{\circ}C)$
3	保存环境 Storage environment	$-5^{\circ}C \sim 40^{\circ}C$ RH < 75%
4	海拔高度 altitude	$\leq 3000m$ 超出范围请咨询厂商)
5	安装扭矩 Install torque	M10 $22 \pm 1N.m$
6	污秽等级 Pollution level	III